

**6th EARSeL SIG IS Workshop**  
European Association of  
Remote Sensing Laboratories Workshop  
at Tel Aviv University,  
Tel Aviv, Israel. March 16-18, 2009



March 2008

Dear Participant,

Enclosed is information to facilitate your participation in the workshop. We suggest you print this letter and bring it with you to Tel Aviv.

**WORKSHOP VENUE**

Beth Hatefutsoth – The Diaspora Museum  
Tel Aviv University, Ramat Aviv, Tel Aviv  
(attached map of the Tel Aviv campus and of Beth Hatefutsoth)

**WORKSHOP HOTELS**

**Grand Beach Hotel**

250 Hayarkon Street

Tel Aviv, Israel

Tel. +972 3 543 3333

Fax. +972 3 546 6589

Check-in time: 14:00, Check-out time: 12:00 (weekdays)

For Saturday arrivals, check-in time is at 17:00 due to the end of the Sabbath (sundown). Rooms may be ready beforehand, based on availability.

**Renaissance Tel Aviv Hotel**

121 Hayarkon Street

Tel Aviv, Israel

Tel. +972 3 521 5555

Fax. +972 3 521 5588

Check-in time: 14:00, Check-out time: 12:00 (weekdays & Saturday)

For Saturday arrivals, there may additional waiting time for check-in due to later check-outs of guests departing on the Sabbath.

**Metropolitan Hotel**

9 - 15 Trumpeldor Street

Tel Aviv, Israel

Tel. +972 3 519 2727

Fax. +972 3 517 2626

Check-in time: 14:00, Check-out time: 12:00 (weekdays & Saturday)

**Sea.Net Hotel**

6 Nes Ziona Street

Tel Aviv, Israel

Tel. +972 3 517 1655

Fax. +972 3 517 1656

Check-in time: 14:00, Check-out time: 12:00 (weekdays & Saturday)

**TRANSPORTATION TO TEL AVIV FROM BEN-GURION AIRPORT**

Taxis are available outside of the Arrivals Hall at Ben-Gurion Airport. The cost of the ride to Tel Aviv is around US\$40.00. Please ask the taxi driver for a rate before departing in the taxi.

# 6th EARSeL SIG IS Workshop

European Association of  
Remote Sensing Laboratories Workshop  
at Tel Aviv University,  
Tel Aviv, Israel. March 16-18, 2009



- 2 -

## REGISTRATION INFORMATION

The workshop registration/hospitality desk will operate as follows:

Sunday, March 15, 2009	16:00 – 18:30	Lobby of the Grand Beach Hotel, Tel Aviv
Monday, March 16, 2009	08:00 – 18:30	Tel Aviv University – Diaspora Museum
Tuesday, March 17, 2009	08:30 – 18:30	Tel Aviv University – Diaspora Museum
Wednesday, March 18, 2009	08:30 – 18:30	Tel Aviv University – Diaspora Museum

## BUS TRANSFER SERVICE/SCHEDULE

During the course of the workshop, there will be a complimentary transfer service provided from the official Tel Aviv workshop hotels to the Tel Aviv University- Diaspora Museum (Beth Hatefutsoth) at Gate #2 and back. Buses will pick-up/drop-off from the workshop hotels outside the reception area/main entrances of each hotel, with the exception of the Sea.Net Hotel. Please be outside the hotel entrances at least 10 minutes prior to your scheduled departure time.

**NOTE:** For guests of the Sea.Net Hotel, departure and return transfers will take place in front of the Metropolitan Hotel (one block away). You can ask the hotel reception desk for simple directions to the Metropolitan Hotel.

## Please see attached time-table for bus transfers

The distance from the hotel strip to Tel Aviv University is about 5km, and takes about 15-20 mins. A one way taxi ride will cost approx. US\$ 10 – 12. Check that the meter is activated at the beginning of your trip.

## WORKSHOP KIT AND NAME TAG

Upon registration you will receive your workshop kit containing the Program, name tag, vouchers for lunches, and social events. Please wear your name tag to all sessions and events.

## WEATHER IN TEL AVIV

The temperature in Tel Aviv in mid-March is approx 19°C (67° F) during the day, and cooler at night. We suggest you bring light clothing for the day and a light jacket for the evening. There is the possibility of rain.

## OPENING SESSION

The Opening Session will be held on Monday, March 16, 2009 at 09:00 in the Large Auditorium, Diaspora Museum (Beth Hatefutsoth), Tel Aviv University.

## WELCOME RECEPTION in honour of Klaus Itten

A Welcome Reception will take place on Monday, March 16, 2009, following the sessions from 18:30 – 19:30 in the foyer outside the Large Auditorium. This will be followed by a tour of the Diaspora Museum. All registered participants and registered accompanying persons are invited to join. **Entrance is by voucher only.**

## MEDITERRANEAN-STYLE DINNER

A Mediterranean-style workshop dinner will take place on Tuesday evening, March 17, 2009 at Kimba, 21 Ha'arba St, Tel Aviv, at 20:00. All registered participants and registered accompanying persons are invited to join. **Entrance is by voucher only.**

## ISIS WORKSHOP

The ISIS Workshop will take place on March 19, 2009, from 09:00 to 13:00 in Classroom 815, Diaspora Museum (Beth Hatefutsoth) Tel Aviv University. Bus transportation is available for pre-registered participants only.

# 6th EARSeL SIG IS Workshop

European Association of  
Remote Sensing Laboratories Workshop  
at Tel Aviv University,  
Tel Aviv, Israel. March 16-18, 2009



- 3 -

## ACCESS TO INTERNET

There will be wireless Internet access available in the area of the workshop venue. Computers will also be available for internet connection, in the foyer outside the lecture halls. As a courtesy to fellow participants, please limit your time on the computers so all may be able to have access.

Kindly note that the Museum computer room is only for research use of the Museum and its activities and internet access will not be available from these computers.

## DRESS CODE

Dress code is informal throughout the workshops. A light jacket or sweater is recommended, as the temperature in Tel Aviv can be cooler in the evening. All rooms (venue and hotels) and vehicles are air conditioned.

## WORKSHOP FIELD TRIPS

Please visit the workshop website for field trip programs:  
<http://www.earsel6th.tau.ac.il/field%20trips.html>

*For both trips remember to take sunglasses, sunscreen and hat and for the Dead Sea trip, bring your bathing suit and sneakers for swimming in the Dead Sea.*

### **Friday, March 20, 2009 – Dead Sea/Masada**

Pre-registration and payment is required for participation on this field trip. Buses will depart from the workshop hotels as follows:

- 07:50 – Departure from Renaissance Hotel (Bus # 2)
- 08:00 – Departure from the Metropolitan Hotel (Bus # 1)
- 08:00 – Departure from the Grand Beach Hotel (Bus # 2)

**Note: for any participants who are not staying at the official workshop hotels, you will need to meet the bus at the RENAISSANCE HOTEL for prompt departure at 07:50.**

Please be outside the hotel entrances at least 10 minutes prior to your scheduled departure time.

**Please bring your voucher, which will be collected on boarding the bus.**

### **Saturday, March 21, 2009 – Ramon Crater**

Pre-registration and payment is required for participation on this field trip. Buses will depart from the workshop hotels as follows:

- 07:40 – Departure from Renaissance Hotel
- 07:50 – Departure from the Metropolitan Hotel
- 08:00 – Departure from the Grand Beach Hotel

**Note: for any participants who are not staying at the official workshop hotels, you will need to meet the bus at the RENAISSANCE HOTEL for prompt departure at 07:40.**

Please be outside the hotel entrances at least 10 minutes prior to your scheduled departure time.

**Please bring your voucher, which will be collected on boarding the bus.**

## DEPARTURES

Check-in time for international flights at Ben-Gurion Airport is 3 hours prior to departure. Taxis may be arranged with your hotel reception desk. Please allow at least forty five minutes for the trip to Ben-Gurion Airport, depending on day of the week and time of day.

## ACCOMMODATION / TOURING SERVICES

Target Conferences Ltd. will be happy to assist with any additional requirements.  
Please inquire at the registration desk.

*Conference Secretariat:* Target Conferences, P.O. Box 29041, Tel Aviv, 61290, Israel  
Tel: +972 3 5175150, Fax: +972 3 5175155, email: [earsel@targetconf.com](mailto:earsel@targetconf.com)

# 6th EARSeL SIG IS Workshop

European Association of  
Remote Sensing Laboratories Workshop  
at Tel Aviv University,  
Tel Aviv, Israel. March 16-18, 2009



- 4 -

## **CURRENCY**

We suggest you exchange a small amount of money for New Israel Shekels on arrival at Ben-Gurion Airport. Optional additional arrangements such as touring and accommodation can be paid for in foreign currency in order to avoid 15.5% VAT.

## **ELECTRICITY**

Electrical equipment in Israel is 220 Volt A.C., single phase, 50 cycles.  
Some appliances require an adapter for the plug (can be purchased locally).

We look forward to welcoming you in Tel Aviv.

*For any assistance, please contact:*

Target Conferences Ltd.

P.O. Box 29041, Tel Aviv 61290

Tel: +972 3 5175150, Fax: +972 3 5175155

e-mail: [earsel@targetconf.com](mailto:earsel@targetconf.com)

**6th EARSeL SIG IS Workshop**  
European Association of  
Remote Sensing Laboratories Workshop  
at Tel Aviv University,  
Tel Aviv, Israel. March 16-18, 2009



**BUS TRANSPORTATION TO/FROM WORKSHOP VENUE**

**Monday, March 16, 2009**

07:45 – Departure from the Renaissance Hotel (Bus # 3)  
07:30 & 07:45 – Departures from the Metropolitan Hotel (Bus #1 & 2)  
08:00 – Departure from the Grand Beach Hotel (Bus #3)

20:30 – Departure from Tel Aviv University- Diaspora Museum, Gate #2 and drop-off at the hotels listed above

**Tuesday, March 17, 2009**

08:10 – Departure from the Renaissance Hotel (Bus # 3)  
08:15 – Departure from the Metropolitan Hotel (Bus # 1 & 2)  
08:20 – Departure from the Grand Beach Hotel (Bus # 3)

18:30 – Departure from Tel Aviv University- Diaspora Museum, Gate #2 to workshop hotels. Hotels guests will have a brief time to freshen up before returning to the buses, which will then depart to Kimba for dinner at the following times:

19:20 – Departure from the Renaissance Hotel (Bus # 3)  
19:30 – Departure from the Metropolitan Hotel (Bus # 1 & 2)  
19:30 – Departure from the Grand Beach Hotel (Bus # 3)

Following dinner, buses will return to the workshop hotels listed above.

**Wednesday, March 18, 2009**

08:10 – Departure from the Renaissance Hotel (Bus # 3)  
08:15 – Departure from the Metropolitan Hotel (Bus # 1 & 2)  
08:20 – Departure from the Grand Beach Hotel (Bus # 3)

19:30 – Departure from Tel Aviv University- Diaspora Museum, Gate #2 and drop-off at the hotels listed above

**Thursday, March 19, 2009 (for ISIS Meeting)**

08:10 –Departure from the Renaissance Hotel  
08:20 –Departure from the Metropolitan Hotel  
08:30 –Departure form the Grand Beach Hotel

13:15 – Departure from Tel Aviv University- Diaspora Museum, Gate #2 and drop-off at the hotels listed above

**March 16-19, 2009**

Participants not staying at official workshop hotels are recommended to catch the first morning bus leaving from the Metropolitan Hotel.

# 6th EARSeL SIG IS Workshop

European Association of  
Remote Sensing Laboratories Workshop  
at Tel Aviv University,  
Tel Aviv, Israel. March 16-18, 2009



## Beth Hatefutsoth Plan

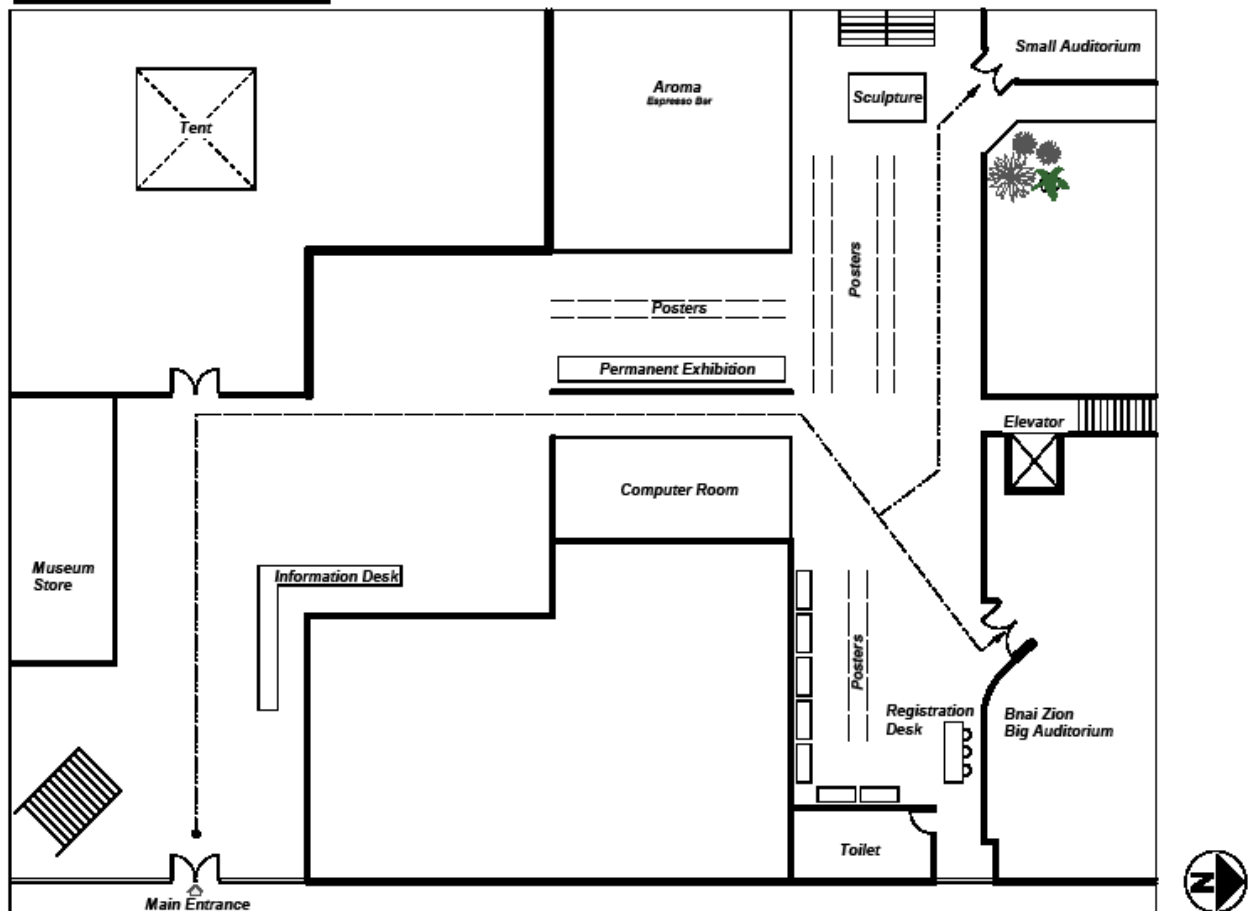



# 6th EARSeL SIG IS Workshop

European Association of  
Remote Sensing Laboratories Workshop  
at Tel Aviv University,  
Tel Aviv, Israel. March 16-18, 2009

